

## TIMING PULLEYS

## 同步带轮

## ■ HTD 5M Series / 系列

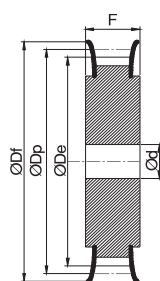

Type A

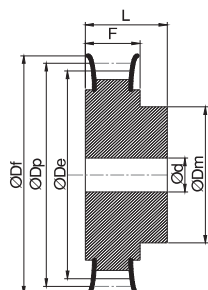

Type B

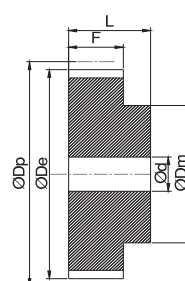

Type C

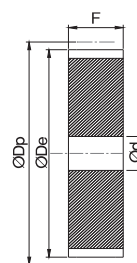

Type D

## • Dimensions / 尺寸

Unit / 单位 : mm

Type 类型	Teeth 齿数	Dp	De	Df	Dm	d	For Belt Width / 同步带宽度					
							9 mm		15 mm		25 mm	
							F	L	F	L	F	L
A, B, C, D	12	19.10	17.96	23	13	4	14.5	20	20.5	26	30.5	36
A, B, C, D	13	20.69	19.55	25	14	5	14.5	20	20.5	26	30.5	36
A, B, C, D	14	22.28	21.14	25	14	5	14.5	20	20.5	26	30.5	36
A, B, C, D	15	23.87	22.73	28	16	5	14.5	20	20.5	26	30.5	36
A, B, C, D	16	25.47	24.33	28	16.5	5	14.5	20	20.5	26	30.5	36
A, B, C, D	18	28.65	27.51	32	20	5	14.5	20	20.5	26	30.5	36
A, B, C, D	20	31.83	30.69	36	23	5	14.5	25.5	20.5	26	30.5	36
A, B, C, D	21	33.42	32.28	38	24	6	14.5	25.5	20.5	26	30.5	38
A, B, C, D	22	35.02	33.88	38	25.5	6	14.5	25.5	20.5	26	30.5	38
A, B, C, D	24	38.20	37.06	42	27	6	14.5	25.5	20.5	28	30.5	38
A, B, C, D	26	41.38	40.24	44	30	6	14.5	25.5	20.5	28	30.5	38
A, B, C, D	28	44.56	43.42	48	30.5	6	14.5	25.5	20.5	28	30.5	38
A, B, C, D	30	47.75	46.61	51	35	6	14.5	25.5	20.5	28	30.5	38
A, B, C, D	32	50.93	49.79	54	38	8	14.5	25.5	20.5	28	30.5	38
A, B, C, D	36	57.30	56.16	60	38	8	14.5	25.5	20.5	28	30.5	38
A, B, C, D	40	63.66	62.52	71	38	8	14.5	25.5	20.5	28	30.5	38
A, B, C, D	44	70.03	68.89	75	38	8	14.5	25.5	20.5	30	30.5	40
A, B, C, D	48	76.40	75.26	83	45	8	14.5	25.5	20.5	30	30.5	40
A, B, C, D	60	95.50	94.36	103	45	8	14.5	25.5	20.5	30	30.5	40
A, B, C, D	72	114.59	113.45	123	45	8	14.5	25.5	20.5	30	30.5	40

- Non-standard Timing Pulleys are machined on request. Please contact us.  
如要求设计非标准规格的同步带轮，请与我们联系。

## ORDERING EXAMPLE

## 订购示例

