

TIMING PULLEYS

同步带轮

■ T 5 Series / 系列

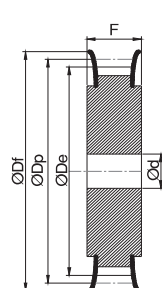

Type A

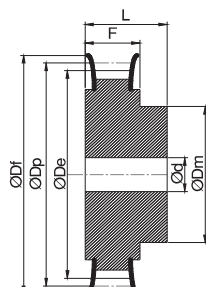

Type B

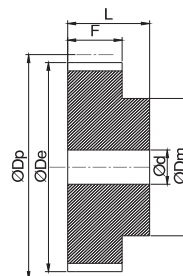

Type C

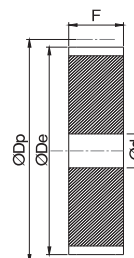

Type D

• Dimensions / 尺寸

Unit / 单位 : mm

Type 类型	Teeth 齿数	D _p	D _e	D _f	D _m	d	For Belt Width / 同步带宽度									
							8 mm		10 mm		16 mm		20 mm		25 mm	
							F	L	F	L	F	L	F	L	F	L
A, B, C, D	10	15.92	15.09	19.5	11	4	13	19	15	21	21	27	25	31	30	36
A, B, C, D	11	17.51	16.68	23	11	4	13	19	15	21	21	27	25	31	30	36
A, B, C, D	12	19.10	18.27	23	11	4	13	19	15	21	21	27	25	31	30	36
A, B, C, D	13	20.69	19.86	25	11	4	13	19	15	21	21	27	25	31	30	36
A, B, C, D	14	22.28	21.45	25	14	5	13	19	15	21	21	27	25	31	30	36
A, B, C, D	15	23.87	23.04	28	16	6	13	19	15	21	21	27	25	31	30	36
A, B, C, D	16	25.47	24.64	32	18	6	13	19	15	21	21	27	25	31	30	36
A, B, C, D	18	28.65	27.82	32	20	6	13	19	15	21	21	27	25	31	30	36
A, B, C, D	19	30.24	29.41	36	22	6	13	19	15	21	21	27	25	31	30	36
A, B, C, D	20	31.83	31.00	36	23	6	13	19	15	21	21	27	25	31	30	36
A, B, C, D	22	35.02	34.19	38	24	6	13	19	15	21	21	27	25	31	30	36
A, B, C, D	24	38.20	37.37	42	26	6	13	19	15	21	21	27	25	31	30	36
A, B, C, D	25	39.79	38.96	44	26	6	13	19	15	21	21	27	25	31	30	36
A, B, C, D	26	41.38	40.55	44	26	6	13	19	15	21	21	27	25	31	30	36
A, B, C, D	27	42.97	42.14	48	30	8	13	19	15	21	21	27	25	31	30	36
A, B, C, D	28	44.56	43.73	48	32	8	13	19	15	21	21	27	25	31	30	36
A, B, C, D	30	47.75	46.92	51	34	8	13	19	15	21	21	27	25	31	30	36
A, B, C, D	32	50.93	50.10	54	38	8	13	19	15	21	21	27	25	31	30	36
A, B, C, D	36	57.30	56.47	63	38	8	13	19	15	21	21	27	25	31	30	36
A, B, C, D	38	60.48	59.65	66	38	8	13	19	15	21	21	27	25	31	30	36
A, B, C, D	40	63.66	62.83	66	40	8	13	19	15	21	21	27	25	31	30	36
A, B, C, D	42	66.85	66.02	71	40	8	13	19	15	21	21	27	25	31	30	36
A, B, C, D	44	70.03	69.20	75	45	8	13	19	15	21	21	27	25	31	30	36
A, B, C, D	45	71.62	70.79	79	45	8	13	19	15	21	21	27	25	31	30	36
A, B, C, D	48	76.40	75.57	83	50	8	13	19	15	21	21	27	25	31	30	36
A, B, C, D	50	79.58	78.75	87	50	8	13	19	15	21	21	27	25	31	30	36
A, B, C, D	60	95.50	94.67	103	65	8	13	19	15	21	21	27	25	31	30	36
A, B, C, D	64	101.86	101.03	111	70	8	13	19	15	21	21	27	25	31	30	36
A, B, C, D	72	114.59	113.76	123	80	8	13	19	15	21	21	27	25	31	30	36
A, B, C, D	80	127.33	126.50	135	90	8	13	19	15	21	21	27	25	31	30	36
A, B, C, D	90	143.24	142.41	153	100	8	13	19	15	21	21	27	25	31	30	36
A, B, C, D	100	159.16	158.33	168	110	8	13	19	15	21	21	27	25	31	30	36

• Non-standard Timing Pulleys are machined on request. Please contact us.

如要求设计非标准规格的同步带轮，请与我们联系。

ORDERING EXAMPLE

订购示例

