

TIMING PULLEYS

同步带轮

XL Series / 系列

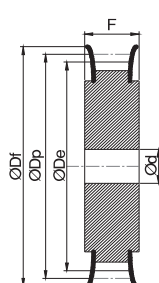

Type A

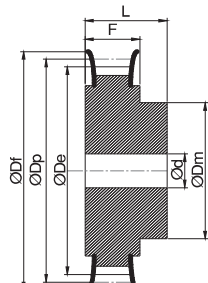

Type B

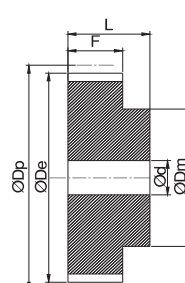

Type C

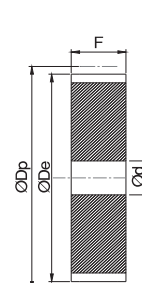

Type D

• Dimensions / 尺寸

Unit / 单位 : mm

Type 类型	Teeth 齿数	Dp	De	Df	Dm	d	For Belt Width / 同步带宽度									
							025		037		050		075		100	
							6.35 mm		9.53 mm		12.7 mm		19.05 mm		25.4 mm	
							F	L	F	L	F	L	F	L	F	L
A, B, C, D	10	16.17	15.66	19.5	11	4	11.1	17	14.3	20	17.5	23	23.8	30	30.2	38
A, B, C, D	11	17.79	17.28	23	11	4	11.1	17	14.3	20	17.5	23	23.8	30	30.2	38
A, B, C, D	12	19.40	18.89	25	13	4	11.1	17	14.3	20	17.5	23	23.8	30	30.2	38
A, B, C, D	13	21.02	20.51	25	13	5	11.1	17	14.3	20	17.5	23	23.8	30	30.2	38
A, B, C, D	14	22.64	22.13	28	16	5	11.1	17	14.3	20	17.5	23	23.8	30	30.2	38
A, B, C, D	15	24.26	23.75	28	16	5	11.1	17	14.3	20	17.5	23	23.8	30	30.2	38
A, B, C, D	16	25.87	25.36	32	20	5	11.1	17	14.3	20	17.5	23	23.8	30	30.2	38
A, B, C, D	17	27.49	26.98	32	20	5	11.1	17	14.3	20	17.5	23	23.8	30	30.2	38
A, B, C, D	18	29.11	28.60	36	22	5	11.1	17	14.3	20	17.5	23	23.8	30	30.2	38
A, B, C, D	19	30.72	30.21	36	22	5	11.1	19	14.3	22	17.5	25	23.8	32	30.2	40
A, B, C, D	20	32.34	31.83	38	25	5	11.1	19	14.3	22	17.5	25	23.8	32	30.2	40
A, B, C, D	21	33.96	33.45	38	25	5	11.1	19	14.3	22	17.5	25	23.8	32	30.2	40
A, B, C, D	22	35.58	35.07	42	25	6	11.1	19	14.3	22	17.5	25	23.8	32	30.2	40
A, B, C, D	24	38.81	38.30	44	30	6	11.1	19	14.3	22	17.5	25	23.8	32	30.2	40
A, B, C, D	25	40.43	39.92	48	30	6	11.1	19	14.3	22	17.5	25	23.8	32	30.2	40
A, B, C, D	26	42.04	41.53	48	30	8	11.1	19	14.3	22	17.5	25	23.8	32	30.2	40
A, B, C, D	27	43.66	43.15	48	34	8	11.1	19	14.3	22	17.5	25	23.8	32	30.2	40
A, B, C, D	28	45.28	44.77	51	34	8	11.1	19	14.3	22	17.5	25	23.8	32	30.2	40
A, B, C, D	29	46.89	46.38	51	34	8	11.1	19	14.3	22	17.5	25	23.8	32	30.2	40
A, B, C, D	30	48.51	48.00	54	38	8	11.1	19	14.3	22	17.5	25	23.8	32	30.2	40
A, B, C, D	32	51.75	51.24	57	38	8	11.1	22	14.3	25	17.5	25	23.8	32	30.2	40
A, B, C, D	34	54.98	54.47	60	45	8	11.1	22	14.3	25	17.5	28	23.8	35	30.2	42
A, B, C, D	35	56.60	56.09	63	45	8	11.1	22	14.3	25	17.5	28	23.8	35	30.2	42
A, B, C, D	36	58.21	57.70	66	45	8	11.1	22	14.3	25	17.5	28	23.8	35	30.2	42
A, B, C, D	38	61.45	60.94	71	45	8	11.1	22	14.3	25	17.5	28	23.8	35	30.2	42
A, B, C, D	40	64.68	64.17	71	45	8	11.1	22	14.3	25	17.5	28	23.8	35	30.2	42
A, B, C, D	42	67.92	67.41	75	45	8	11.1	22	14.3	25	17.5	28	23.8	35	30.2	42
A, B, C, D	44	71.15	70.64	79	45	8	11.1	22	14.3	25	17.5	28	23.8	35	30.2	42
A, B, C, D	45	72.77	72.26	79	45	8	11.1	22	14.3	25	17.5	28	23.8	35	30.2	42
A, B, C, D	46	74.38	73.87	83	45	8	11.1	22	14.3	25	17.5	28	23.8	35	30.2	42
A, B, C, D	48	77.62	77.11	83	45	10	11.1	22	14.3	25	17.5	28	23.8	35	30.2	42
A, B, C, D	50	80.85	80.34	87	45	10	11.1	22	14.3	25	17.5	28	23.8	35	30.2	42
A, B, C, D	52	84.09	83.58	91	45	10	11.1	22	14.3	25	17.5	28	23.8	35	30.2	42
A, B, C, D	56	90.56	90.05	97	45	10	11.1	22	14.3	25	17.5	28	23.8	35	30.2	42
A, B, C, D	60	97.02	96.51	103	45	10	11.1	22	14.3	25	17.5	28	23.8	35	30.2	42
A, B, C, D	64	103.49	102.98	111	45	10	11.1	22	14.3	25	17.5	28	23.8	35	30.2	42
A, B, C, D	72	116.43	115.92	123	45	10	11.1	22	14.3	25	17.5	28	23.8	35	30.2	42

• Non-standard Timing Pulleys are machined on request. Please contact us.

如要求设计非标准规格的同步带轮，请与我们联系。

ORDERING EXAMPLE

订购示例

ST 28 XL 037 - B
 AL - Aluminium / 铝
 ST - Steel / 钢
 No. of Teeth / 齿数
 Type / 类型 : A, B, C, D
 Belt Width / 同步带宽 : 025 = 6.35mm
 XL Series / 系列